

INSTRUCTION SHEET

φ 16 Switch Guard (EMO/EMS(Protective Shroud))

XA Series

Confirm that the delivered product is what you have ordered.
Read this instruction sheet to make sure of correct operation.
Make sure that the instruction sheet is kept by the end user.

SAFETY NOTE

Turn off the power to the switch before starting installation,
wiring, maintenance and inspection of the switch. Failure to
turn power off may cause electric shock or fire hazard.

1 Type No.

XA9Z-KG1

2 Applicable Standards

ISO13850 and SEMI-S2.

(*Applicable switch is only the combination described below.)

3 Applicable Switches for the Switch Guard

Switch Guard	Applicable Switches
XA9Z-KG1	XA1E-BV3, XA1E-LV3, XA1E-BV4, XA1E-LV4

4 Panel Mounting

Panel Mounting

Face the TOP marking on the operator and the Switch guard
upward and align anti-rotation of the operator unit with the key
groove of the panel cut-out, then tighten the locking ring using
ring wrench MT-001 to a torque of 0.88 N·m.

NOTE: Please note that if the anti-rotation and key groove can
not be surely fitted, otherwise the normal waterproof and
dustproof characteristics are not ensured.

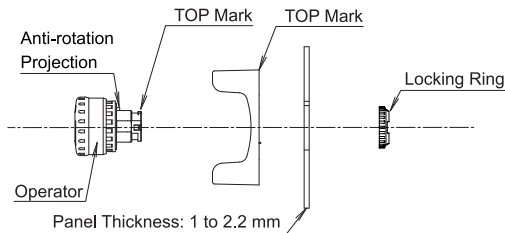

Mounting Height Range

When mounting on semiconductor manufacturing equipment,
locate the panel cut-out for the EMO switch guard at a
maximum height of 1638 mm (64.5 in.) and a minimum height
of 838 mm (33 in.). (SEMI S8)

When mounting on a machine tool or a food processing
machine, should be to place the panel cutout of the switch
guard at a maximum height of 1700mm and a minimum height
of 600 mm.(ISO13850)

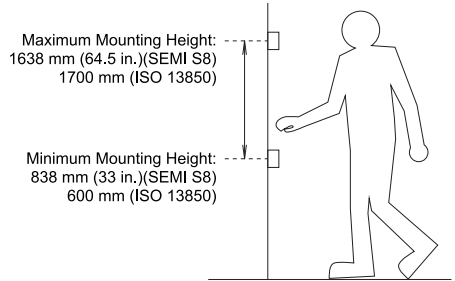

Panel Cut-out

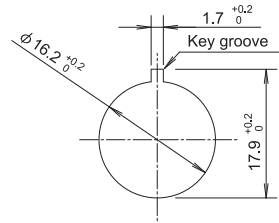

5 Notes for Operation

• All Circuits should be fault-tolerant.

• Only in cases where it is impossible to prevent unintentional
operation by the installation position in safety requirements of
ISO 13850 in machinery equipment such as machine tools and
food machines subject to ISO / IEC, It is permitted to use
emergency stop switches with switch guard.

6 Precaution for Disposal

Dispose of the Switch Guard as an industrial waste.